

Landscape Maintenance Plan	
Task	Time Period
Planting of local drought tolerant plants (refer Plant Schedule)	Upon construction of perimeter fence
Water at planting & then fortnightly	1st & 2nd month after planting
Maintenance (watered by rainfall or as required)	
Visual inspection once a month ensuring plants are alive	3rd to 5th month after planting
Visual inspection once every 3 months ensuring plants are alive	6th to 8th month after planting
Visual inspection once every 6 months ensuring plants are alive	9th month to 30 years after planting
Note: (1) Any dead, diseased or damaged plants will be replaced as soon as possible by maintenance services team. (2) The Landscape Maintenance Plan has been prepared in accordance with advice from Green Gold Energy P/L. Disclaimer: Chris Smith & Associates P/L. take no responsibility for the implementation of the Landscape Maintenance Plan. Landscape Plan to be read in conjunction with F&L Survey, Title Reestablishment Survey & Site Plan	

Plant Schedule					
Botanical Name	Common Name	Planting Size	Mature Size	Symbol	Total (approx)
Callistemon Citrinus	Kings Park Special	50mm Tube with Bio-Guard	3-4m H x 2m W		32 No.
Koelreuteria Bipinnata	Pride of China	50mm Tube with Bio-Guard	6-8m H x 6m W		20 No.
Callistemon Salignus	Pink Tip Bottle Brush	50mm Tube with Bio-Guard	2-2.5m H x 2m W		132 No.
					184 No.

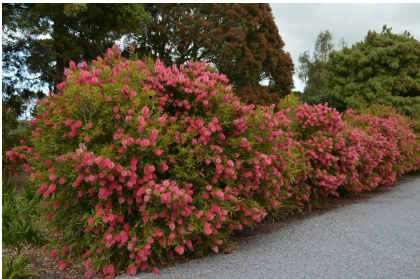

B: Callistemon Salignus
C: Pink Tip Bottle Brush



B: Koelreuteria Bipinnata
C: Pride of China



B: Callistemon Citrinus
C: Kings Park Special

Legend:

- Areas of Double Row of Plants
- Areas of Triple Row of Plants

Landscape Construction Notes:

- Landscape Construction.**
 - Contractor to ensure all measurements on site are correct, accurate & relevant to site.
 - All planted areas are required to have a minimum of 150mm cultivated topsoil.
 - Finished level of topsoil to be 100 - 150mm above existing surface level to ensure planted areas are free from water-logging during wet periods.
- Locate all existing services.**
 - Contractor to ensure a Dial Before You Dig is undertaken and are to be aware of all underground services and are located as relevant.
- Plant Supply.**
 - All supplied plants are to be healthy & free of any pests, diseases and of an attractive natural.
 - Root systems are not to be root bound & to have a well formed root system commensurate in size with the foliage mass.

Proposed planting of 46 plants
(Double row of Pride of China & Pink Tip Bottle Brush)
Refer to details

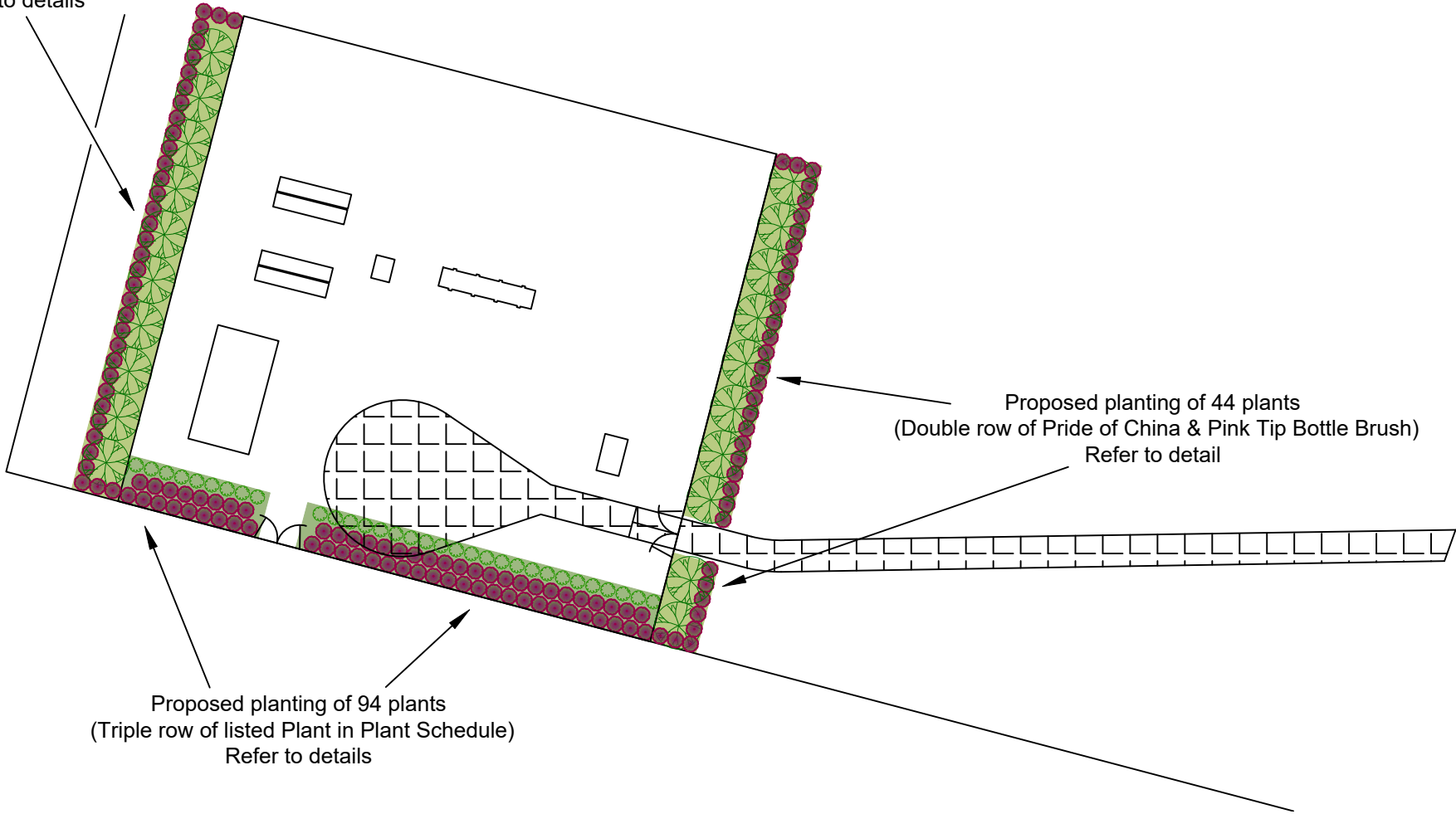

* Please be aware that vegetation planted in Powerline Buffer must not exceed 4m in mature height with no climbable part over 2.5m in height.

** All Weeping Myall are to be maintained to a maximum of 6m in height & 6m in width.



REVISION	DATE	ZONE
1	New site plan update	10/02/25

NOTE 1
BEWARE OF EXISTING
OVERHEAD POWER CABLES.

WARNING
BEWARE OF UNDERGROUND SERVICES
The locations of underground services are approximate only and their exact position should be proven on site. No guarantee is given that all existing services are shown.

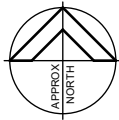

Scale 1 : 800 @ A3

Chris Smith
& ASSOCIATES

PTY LTD
· CIVIL ENGINEERS · LAND SURVEYORS
· URBAN & REGIONAL PLANNERS · PROJECT MANAGERS
LEVEL 1 / 135 FRYERS STREET, SHEPPARTON, VIC. 3630
PH: (03) 5820 7700 FAX: (03) 5822 4878 www.csmith.com.au
Designed Dylan Stevens January 2025
Drawn Dylan Stevens January 2025
Checked Duncan Lewis January 2025
Approved

Green Gold Energy Pty Ltd
4.95MW B.E.S.S
3 Wellingrove Street
Glen Innes, NSW, 2370
Landscape Plan
Site Plan, Plant Schedule & Maintenance Plan
Drawing No. 24233/LS01 Rev. 1
Sheet No. 1 of 2 24233-LS01r1.dwg
© Chris Smith & Associates ABN 14 627 882 064
THIS DOCUMENT IS COPYRIGHT AND MAY ONLY BE USED FOR THE PURPOSE FOR WHICH IT WAS COMMISSIONED. UNAUTHORISED USE PROHIBITED. ALL DIMENSIONS AND LEVELS TO BE CHECKED ON THE PROJECT BEFORE COMMENCING ANY WORKS OR SHOP DRAWINGS. DRAWINGS NOT TO BE SCALED.

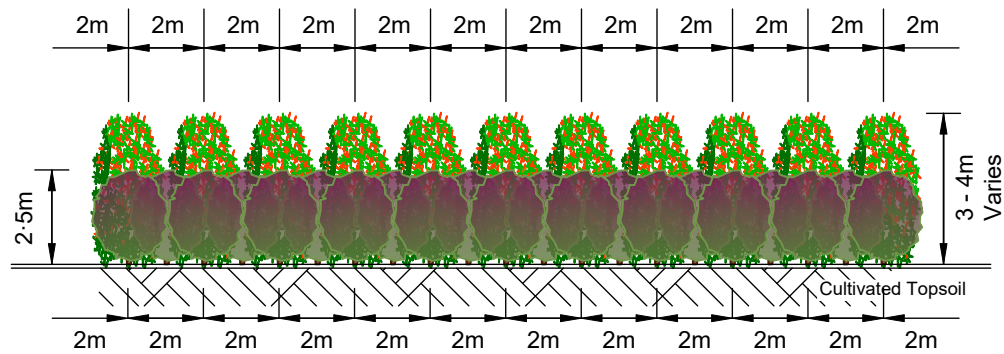

Elevation & Spacing: Triple Row Perimeter Screening

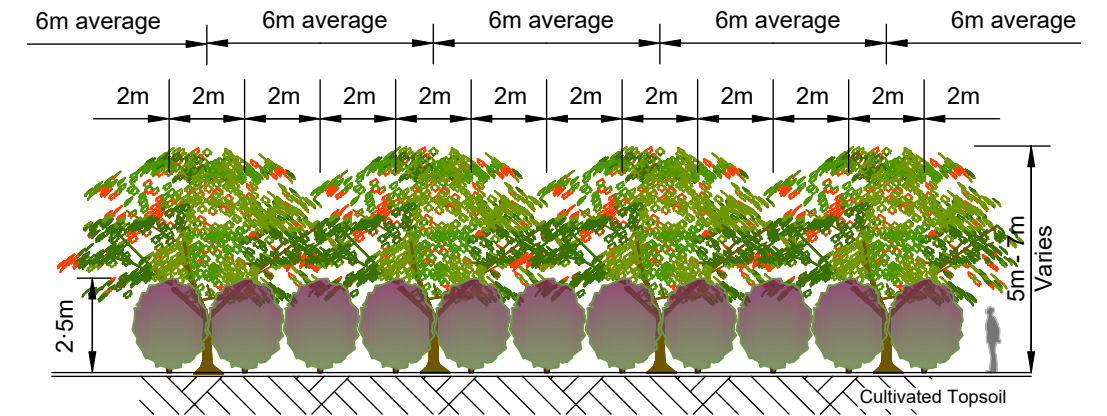

Elevation & Spacing: Double Row Perimeter Screening

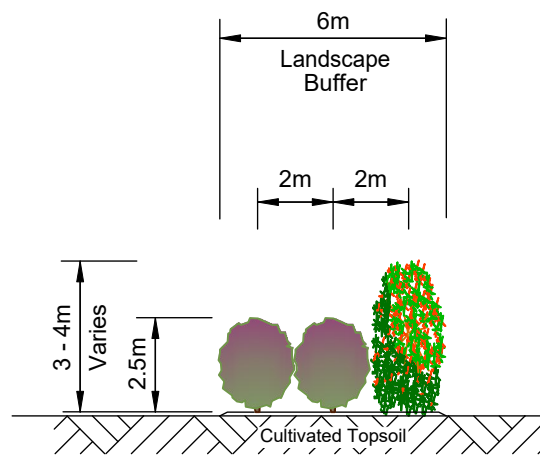

Triple Row Cross Section

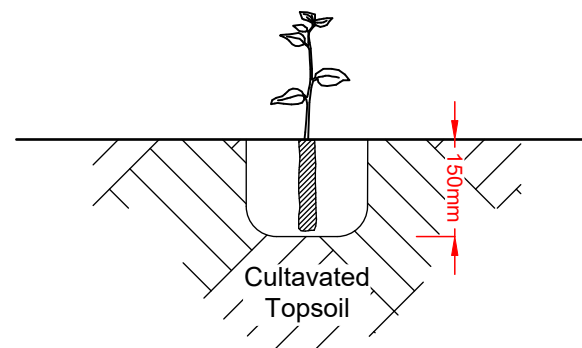

Planting Detail - 50mm Tube Stock

N.T.S

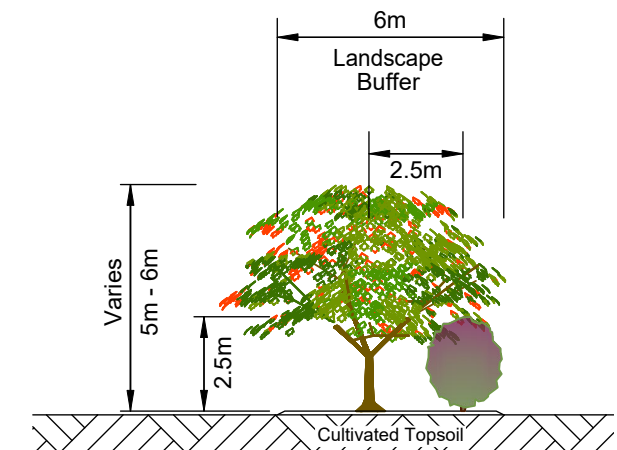

Triple Row Cross Section

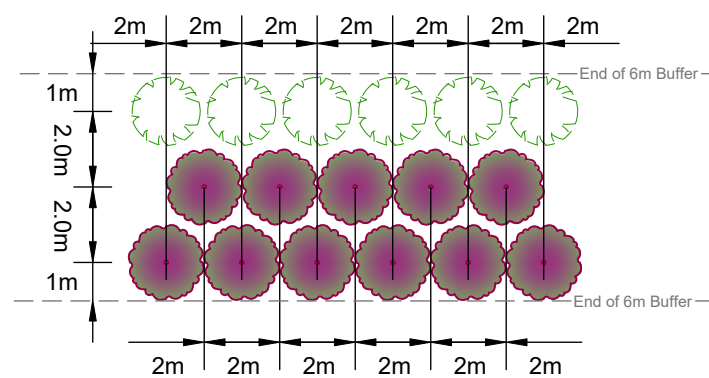

Spacing: Triple Row Perimeter Screening

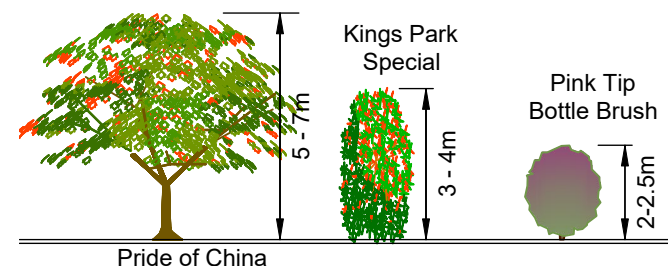

Tree Profiles/Elevations

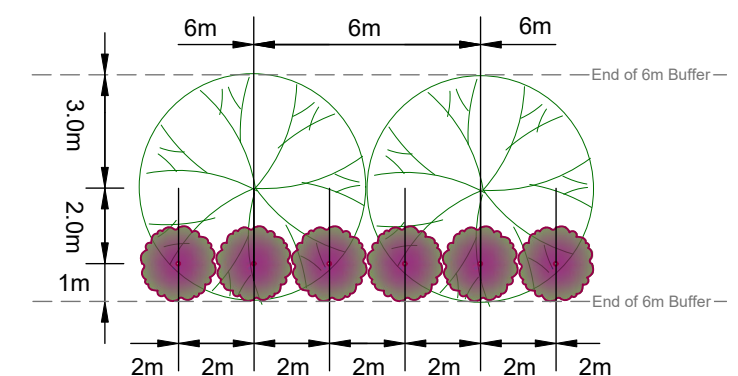

Spacing: Double Row Perimeter Screening



REVISION	DATE	ZONE
1 New site plan update	10/02/25	

NOTE 1
BEWARE OF EXISTING
OVERHEAD POWER CABLES.

WARNING
BEWARE OF UNDERGROUND SERVICES
The locations of underground services are approximate only and their exact position should be proven on site. No guarantee is given that all existing services are shown.

Chris Smith

& ASSOCIATES

PTY LTD
· CIVIL ENGINEERS · LAND SURVEYORS
· URBAN & REGIONAL PLANNERS · PROJECT MANAGERS
LEVEL 1 / 135 FRYERS STREET, SHEPPARTON, VIC. 3630
PH: (03) 5820 7700 FAX: (03) 5822 4878 www.csmith.com.au
Designed Dylan Stevens January 2025
Drawn Dylan Stevens January 2025
Checked Duncan Lewis January 2025
Approved

Green Gold Energy Pty Ltd
5MW B.E.S.S

3 Wellingrove Street

Glen Innes, NSW, 2370

Landscape Plan

Typical Elevations, Details & Spacings

Drawing No. 24233/LS01

Rev. 1

Sheet No. 2 of 2

24233-LS01r1.dwg

© Chris Smith & Associates ABN 14 627 882 064
THIS DOCUMENT IS COPYRIGHT AND MAY ONLY BE USED FOR THE PURPOSE FOR WHICH IT WAS COMMISSIONED. UNAUTHORISED USE PROHIBITED. ALL DIMENSIONS AND LEVELS TO BE CHECKED ON THE PROJECT BEFORE COMMENCING ANY WORKS OR SHOP DRAWINGS.
DRAWINGS NOT TO BE SCALED.

0
Scale NTS